

CARBIDE



Being the best through innovation



V7 Mill INOX

- 可对HRc40以下的不锈钢进行重切削和无声切削
- 以变化螺旋角设计, YG-1专利

**Stainless Steels in Heavy and Silent Cutting Materials up to HRc40.
Designed as Variable Leads, YG-1's Patent.**

SELECTION GUIDE

项目	型号	规格	尺寸		页
			最小	最大	
ITEM	MODEL	DESCRIPTION	SIZE		PAGE
			MIN	MAX	

METRIC

EMB41 EMB42		硬质合金, 4刃 短刃 CARBIDE, 4 FLUTE SHORT LENGTH	D3.0	D20.0	714
EMB43 EMB44		硬质合金, 4刃 短刃 圆鼻铣刀 CARBIDE, 4 FLUTE SHORT LENGTH CORNER RADIUS	D3.0	D20.0	715
EMB14 EMB39		硬质合金, 4刃 长刃 CARBIDE, 4 FLUTE LONG LENGTH	D3.0	D25.0	716
EMB15 EMB40		硬质合金, 4刃 长刃 圆鼻铣刀 CARBIDE, 4 FLUTE LONG LENGTH CORNER RADIUS	D3.0	D25.0	717
EMB74 EMB75		硬质合金, 4刃 长刃 球头 CARBIDE, 4 FLUTE LONG LENGTH BALL NOSE	R1.5	R12.5	718
EMB72 EMB73		硬质合金, 5刃 长刃 CARBIDE, 5 FLUTE LONG LENGTH	D6.0	D25.0	719

INCH

EMB12 EMB37		硬质合金, 4刃 普通刃 CARBIDE, 4 FLUTE REGULAR LENGTH	D1/8"	D1"	720
EMB13 EMB38		硬质合金, 4刃 普通刃 圆鼻铣刀 CARBIDE, 4 FLUTE REGULAR LENGTH CORNER RADIUS	D1/8"	D1"	721
EMB78 EMB79		硬质合金, 4刃 普通刃 球头 CARBIDE, 4 FLUTE REGULAR LENGTH BALL NOSE	R1/16"	R1/2"	722
EMB76 EMB77		硬质合金, 5刃 普通刃 CARBIDE, 5 FLUTE REGULAR LENGTH	D1/4"	D1"	723
推荐的切削条件 RECOMMENDED CUTTING CONDITIONS					724

V7 Mill INOX END MILLS

◎ : 优(Excellent) ○ : 良(Good)

碳钢	合金钢	预硬钢	硬化钢		高硬钢	铜	石墨	铸铁	铝	不锈钢	钛	铬镍铁合金
Carbon Steels	Alloy Steels	Prehardened Steels	Hardened Steels		High Hardened Steels	Copper	Graphite	Cast Iron	Aluminum	Stainless Steels	Titanium	Inconel
~HB225	HB225~325	HRc30~40	HRc40~45	HRc45~55	HRc55~70							

◎	○	○								◎	◎	○
◎	○	○								◎	◎	○
◎	○	○								◎	◎	○
◎	○	○								◎	◎	○
◎	○	○								◎	◎	○
◎	○	○								◎	◎	○

◎	○	○								◎	◎	○
◎	○	○								◎	◎	○
◎	○	○								◎	◎	○
◎	○	○								◎	◎	○

硬质合金, 4刃 短刃
CARBIDE, 4 FLUTE SHORT LENGTH

- ▶ 特殊的沟槽几何形状可以消除振动
- ▶ 设计用于加工低碳钢, 不锈钢, 铸铁, 工具钢, 钛合金, 预硬钢和硬度在HRc40以下的低硬化钢
- ▶ 卓越的工件的表面粗糙度
- ▶ 高速度, 较深切削和材料切除率

- ▶ Special flute geometry eliminates vibrations.
- ▶ Designed to mild steels, stainless steels, cast iron, tool steels, titanium alloys, prehardened steels and low hardness materials under HRc 40
- ▶ Excellent work piece finishes
- ▶ Higher speeds, deeper cuts and metal removal rates



P.724

单位(Unit) : mm

型号 EDP No.		刃部直径 Mill Diameter	柄部直径 Shank Diameter h6	刃长 Length of Cut	全长 Overall Length
PLAIN	FLAT				
EMB41030	EMB42030	3.0	6	7	54
EMB41040	EMB42040	4.0	6	8	54
EMB41050	EMB42050	5.0	6	10	54
EMB41060	EMB42060	6.0	6	10	54
EMB41080	EMB42080	8.0	8	12	58
EMB41100	EMB42100	10.0	10	14	66
EMB41120	EMB42120	12.0	12	16	73
EMB41140	EMB42140	14.0	14	18	75
EMB41160	EMB42160	16.0	16	22	82
EMB41180	EMB42180	18.0	18	24	84
EMB41200	EMB42200	20.0	20	26	92

刃部公差 Mill Dia. Tolerance(mm)	柄部公差 Shank Dia. Tolerance
0~-0.03	h6

◎ : 优(Excellent) ○ : 良(Good)

碳钢 Carbon Steels	合金钢 Alloy Steels	预硬钢 Prehardened Steels	硬化钢 Hardened Steels		高硬钢 High Hardened Steels	铜 Copper	石墨 Graphite	铸铁 Cast Iron	铝 Aluminum	不锈钢 Stainless Steels	钛 Titanium	镍铬铁合金 Inconel
~HB225	HB225~325	HRc30~40	HRc40~45	HRc45~55	HRc55~70							
◎	○	○								◎	◎	○



EMB43 SERIES

PLAIN SHANK

EMB44 SERIES

FLAT SHANK

硬质合金, 4刃 短刃 圆鼻铣刀

CARBIDE, 4 FLUTE SHORT LENGTH CORNER RADIUS

- ▶ 特殊的沟槽几何形状可以消除振动
- ▶ 设计用于加工低碳钢, 不锈钢, 铸铁, 工具钢, 钛合金, 预硬钢和硬度在H Rc 40以下的低硬化钢
- ▶ 卓越的工件的表面粗糙度
- ▶ 高速度, 较深切削和材料切除率

- ▶ Special flute geometry eliminates vibrations.
- ▶ Designed to mild steels, stainless steels, cast iron, tool steels, titanium alloys, prehardened steels and low hardness materials under HRc 40
- ▶ Excellent work piece finishes
- ▶ Higher speeds, deeper cuts and metal removal rates



单位(Unit) : mm

型号 EDP No.		圆弧半径 Corner Radius	刃部直径 Mill Diameter	柄部直径 Shank Diameter	刃长 Length of Cut	全长 Overall Length
PLAIN	FLAT	R		h6		
EMB43030	EMB44030	RO.25~RO.38	3.0	6	7	54
EMB43040	EMB44040	RO.25~RO.38	4.0	6	8	54
EMB43050	EMB44050	RO.25~RO.38	5.0	6	10	54
EMB43060	EMB44060	RO.38~RO.51	6.0	6	10	54
EMB43080	EMB44080	RO.38~RO.51	8.0	8	12	58
EMB43100	EMB44100	RO.38~RO.51	10.0	10	14	66
EMB43120	EMB44120	RO.64~RO.76	12.0	12	16	73
EMB43140	EMB44140	RO.64~RO.76	14.0	14	18	75
EMB43160	EMB44160	RO.89~R1.02	16.0	16	22	82
EMB43180	EMB44180	RO.89~R1.02	18.0	18	24	84
EMB43200	EMB44200	RO.89~R1.02	20.0	20	26	92

刃部公差 Mill Dia. Tolerance(mm)	柄部公差 Shank Dia. Tolerance
0~-0.03	h6

碳钢 Carbon Steels	合金钢 Alloy Steels	预硬钢 Prehardened Steels	硬化钢 Hardened Steels		高硬钢 High Hardened Steels	铜 Copper	石墨 Graphite	铸铁 Cast Iron	铝 Aluminum	不锈钢 Stainless Steels	钛 Titanium	镍铁合金 Inconel
-HB225	HB225~325	HRc30~40	HRc40~45	HRc45~55	HRc55~70							
◎	○	○								◎	◎	○

◎ : 优(Excellent) ○ : 良(Good)

HSS

CBN
END MILLSi-Xmill
END MILLSX5070
END MILLSX-POWER
END MILLSJET-POWER
END MILLSV7 Mill INOX
END MILLSV7 Mill STEEL
END MILLSALU-POWER
END MILLS

CRX S

D-POWER
END MILLSK-2 CARBIDE
END MILLSGENERAL
CARBIDE
END MILLSTANK-POWER
END MILLSGENERAL
HSS
END MILLSMILLING
CUTTERSTECHNICAL
DATA



硬质合金, 4刃 长刃
CARBIDE, 4 FLUTE LONG LENGTH

- ▶ 特殊的沟槽几何形状可以消除振动
 - ▶ 设计用于加工低碳钢, 不锈钢, 铸铁, 工具钢, 钛合金, 预硬钢和硬度在HRc40以下的低硬化钢
 - ▶ 卓越的工件的表面粗糙度
 - ▶ 高速度, 较深切削和材料切除率
- ▶ Special flute geometry eliminates vibrations.
 - ▶ Designed to mild steels, stainless steels, cast iron, tool steels, titanium alloys, prehardened steels and low hardness materials under HRc 40
 - ▶ Excellent work piece finishes
 - ▶ Higher speeds, deeper cuts and metal removal rates



型号		刃部直径	柄部直径	刃长	全长
EDP No.		Mill Diameter	Shank Diameter	Length of Cut	Overall Length
PLAIN	FLAT		h6		
EMB14030	EMB39030	3.0	6	8	57
EMB14040	EMB39040	4.0	6	11	57
EMB14050	EMB39050	5.0	6	13	57
EMB14060	EMB39060	6.0	6	13	57
EMB14080	EMB39080	8.0	8	19	63
EMB14100	EMB39100	10.0	10	22	72
EMB14120	EMB39120	12.0	12	26	83
EMB14140	EMB39140	14.0	14	26	83
EMB14160	EMB39160	16.0	16	32	92
EMB14180	EMB39180	18.0	18	32	92
EMB14200	EMB39200	20.0	20	38	104
EMB14250	EMB39250	25.0	25	38	104

单位(Unit) : mm

刃部公差	柄部公差
Mill Dia. Tolerance(mm)	Shank Dia. Tolerance
0~-0.03	h6

碳钢	合金钢	预硬钢	硬化钢		高硬钢	铜	石墨	铸铁	铝	不锈钢	钛	镍铬铁合金
Carbon Steels	Alloy Steels	Prehardened Steels	Hardened Steels		High Hardened Steels	Copper	Graphite	Cast Iron	Aluminum	Stainless Steels	Titanium	Inconel
~HB225	HB225~325	HRc30~40	HRc40~45	HRc45~55	HRc55~70							
◎	○	○								◎	◎	○

◎ : 优(Excellent) ○ : 良(Good)

硬质合金, 4刃 长刃 圆鼻铣刀
CARBIDE, 4 FLUTE LONG LENGTH CORNER RADIUS

- ▶ 特殊的沟槽几何形状可以消除振动
- ▶ 设计用于加工低碳钢, 不锈钢, 铸铁, 工具钢, 钛合金, 预硬钢和硬度在H Rc 40以下的低硬化钢
- ▶ 卓越的工件的表面粗糙度
- ▶ 高速度, 较深切削和材料切除率

- ▶ Special flute geometry eliminates vibrations.
- ▶ Designed to mild steels, stainless steels, cast iron, tool steels, titanium alloys, prehardened steels and low hardness materials under HRc 40
- ▶ Excellent work piece finishes
- ▶ Higher speeds, deeper cuts and metal removal rates



单位(Unit) : mm

型号 EDP No.		圆弧半径 Corner Radius	刃部直径 Mill Diameter	柄部直径 Shank Diameter	刃长 Length of Cut	全长 Overall Length
PLAIN	FLAT	R		h6		
EMB15030	EMB40030	RO.25~RO.38	3.0	6	8	57
EMB15040	EMB40040	RO.25~RO.38	4.0	6	11	57
EMB15050	EMB40050	RO.25~RO.38	5.0	6	13	57
EMB15060	EMB40060	RO.38~RO.51	6.0	6	13	57
EMB15080	EMB40080	RO.38~RO.51	8.0	8	19	63
EMB15100	EMB40100	RO.38~RO.51	10.0	10	22	72
EMB15120	EMB40120	RO.64~RO.76	12.0	12	26	83
EMB15140	EMB40140	RO.64~RO.76	14.0	14	26	83
EMB15160	EMB40160	RO.89~R1.02	16.0	16	32	92
EMB15180	EMB40180	RO.89~R1.02	18.0	18	32	92
EMB15200	EMB40200	RO.89~R1.02	20.0	20	38	104
EMB15250	EMB40250	RO.89~R1.02	25.0	25	38	104

刃部公差 Mill Dia. Tolerance(mm)	柄部公差 Shank Dia. Tolerance
0~-0.03	h6

◎ : 优(Excellent) ○ : 良(Good)

碳钢	合金钢	预硬钢	硬化钢		高硬钢	铜	石墨	铸铁	铝	不锈钢	钛	镍铁合金
Carbon Steels	Alloy Steels	Prehardened Steels	Hardened Steels		High Hardened Steels	Copper	Graphite	Cast Iron	Aluminum	Stainless Steels	Titanium	Inconel
~HB225	HB225~325	HRc30~40	HRc40~45	HRc45~55	HRc55~70							
◎	○	○								◎	◎	○



硬质合金, 4刃 长刃 球头
CARBIDE, 4 FLUTE LONG LENGTH BALL NOSE

- ▶ 特殊的沟槽几何形状可以消除振动
 - ▶ 设计用于加工低碳钢, 不锈钢, 铸铁, 工具钢, 钛合金, 预硬钢和硬度在HRc40以下的低硬化钢
 - ▶ 卓越的工件的表面粗糙度
 - ▶ 高速度, 较深切削和材料切除率
- ▶ Special flute geometry eliminates vibrations.
 - ▶ Designed to mild steels, stainless steels, cast iron, tool steels, titanium alloys, prehardened steels and low hardness materials under HRc 40
 - ▶ Excellent work piece finishes
 - ▶ Higher speeds, deeper cuts and metal removal rates



单位(Unit) : mm

型号 EDP No.		球头半径 Radius of Ball Nose	刃部直径 Mill Diameter	柄部直径 Shank Diameter	刃长 Length of Cut	全长 Overall Length
PLAIN	FLAT	R (±0.01)		h6		
EMB74030	EMB75030	R1.5	3.0	6	8	57
EMB74040	EMB75040	R2.0	4.0	6	11	57
EMB74050	EMB75050	R2.5	5.0	6	13	57
EMB74060	EMB75060	R3.0	6.0	6	13	57
EMB74080	EMB75080	R4.0	8.0	8	19	63
EMB74100	EMB75100	R5.0	10.0	10	22	72
EMB74120	EMB75120	R6.0	12.0	12	26	83
EMB74160	EMB75160	R8.0	16.0	16	32	92
EMB74200	EMB75200	R10.0	20.0	20	38	104
EMB74250	EMB75250	R12.5	25.0	25	38	104

刃部公差 Mill Dia. Tolerance(mm)	柄部公差 Shank Dia. Tolerance
0~-0.03	h6

◎ : 优(Excellent) ○ : 良(Good)

碳钢 Carbon Steels	合金钢 Alloy Steels	预硬钢 Prehardened Steels	硬化钢 Hardened Steels		高硬钢 High Hardened Steels	铜 Copper	石墨 Graphite	铸铁 Cast Iron	铝 Aluminum	不锈钢 Stainless Steels	钛 Titanium	镍铬铁合金 Inconel
~HB225	HB225~325	HRc30~40	HRc40~45	HRc45~55	HRc55~70							
◎	○	○								◎	◎	○



硬质合金, 5刃 长刃
CARBIDE, 5 FLUTE LONG LENGTH

- ▶ 特殊的沟槽几何形状可以消除振动
- ▶ 设计用于加工低碳钢, 不锈钢, 铸铁, 工具钢, 钛合金, 预硬钢和硬度在H Rc 40以下的低硬化钢
- ▶ 卓越的工件的表面粗糙度
- ▶ 高速度, 较深切削和材料切除率

- ▶ Special flute geometry eliminates vibrations.
- ▶ Designed to mild steels, stainless steels, cast iron, tool steels, titanium alloys, prehardened steels and low hardness materials under HRc 40
- ▶ Excellent work piece finishes
- ▶ Higher speeds, deeper cuts and metal removal rates

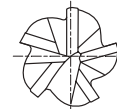

型号		刃部直径 Mill Diameter	柄部直径 Shank Diameter h6	刃长 Length of Cut	单位(Unit) : mm	
EDP No.					全长 Overall Length	
PLAIN	FLAT					
EMB72060	EMB73060	6.0	6	13		57
EMB72080	EMB73080	8.0	8	19		63
EMB72100	EMB73100	10.0	10	22		72
EMB72120	EMB73120	12.0	12	26		83
EMB72140	EMB73140	14.0	14	26		83
EMB72160	EMB73160	16.0	16	32		92
EMB72180	EMB73180	18.0	18	32		92
EMB72200	EMB73200	20.0	20	38		104
EMB72250	EMB73250	25.0	25	38		104

刃部公差 Mill Dia. Tolerance(mm)	柄部公差 Shank Dia. Tolerance
0~-0.03	h6

◎ : 优(Excellent) ○ : 良(Good)

碳钢	合金钢	预硬钢	硬化钢		高硬钢	铜	石墨	铸铁	铝	不锈钢	钛	镍铁合金
Carbon Steels	Alloy Steels	Prehardened Steels	Hardened Steels		High Hardened Steels	Copper	Graphite	Cast Iron	Aluminum	Stainless Steels	Titanium	Inconel
~HB225	HB225~325	HRc30~40	HRc40~45	HRc45~55	HRc55~70							
◎	○	○								◎	◎	○

HSS

CBN
END MILLS

i-Xmill
END MILLS

X5070
END MILLS

X-POWER
END MILLS

JET-POWER
END MILLS

V7 Mill INOX
END MILLS

V7 Mill STEEL
END MILLS

ALU-POWER
END MILLS

CRX S

D-POWER
END MILLS

K-2 CARBIDE
END MILLS

GENERAL
CARBIDE
END MILLS

TANK-POWER
END MILLS

GENERAL
HSS
END MILLS

MILLING
CUTTERS

TECHNICAL
DATA



EMB12 SERIES

PLAIN SHANK

EMB37 SERIES

FLAT SHANK

硬质合金, 4刃 普通刃
CARBIDE, 4 FLUTE REGULAR LENGTH

- ▶ 特殊的沟槽几何形状可以消除振动
- ▶ 设计用于加工低碳钢, 不锈钢, 铸铁, 工具钢, 钛合金, 预硬钢和硬度在HRc40以下的低硬化钢
- ▶ 卓越的工件的表面粗糙度
- ▶ 高速度, 较深切削和材料切除率

- ▶ Special flute geometry eliminates vibrations.
- ▶ Designed to mild steels, stainless steels, cast iron, tool steels, titanium alloys, prehardened steels and low hardness materials under HRc 40
- ▶ Excellent work piece finishes
- ▶ Higher speeds, deeper cuts and metal removal rates



单位(Unit) : inch

型号 EDP No.		刃部直径 Mill Diameter	柄部直径 Shank Diameter h6	刃长 Length of Cut	全长 Overall Length
PLAIN	FLAT				
EMB12008	-	1/8	1/8	3/8	1-1/2
EMB12010	-	5/32	3/16	7/16	2
EMB12012	-	3/16	3/16	7/16	2
EMB12014	-	7/32	1/4	7/16	2-1/2
EMB12016	-	1/4	1/4	1/2	2-1/2
EMB12018	-	9/32	5/16	5/8	2-1/2
EMB12020	-	5/16	5/16	13/16	2-1/2
EMB12022	EMB37022	11/32	3/8	13/16	2-1/2
EMB12024	EMB37024	3/8	3/8	7/8	2-1/2
EMB12026	EMB37026	13/32	7/16	15/16	2-3/4
EMB12028	EMB37028	7/16	7/16	1	2-3/4
EMB12030	EMB37030	15/32	1/2	1	3
EMB12032	EMB37032	1/2	1/2	1	3
EMB12036	EMB37036	9/16	9/16	1-1/8	3-1/2
EMB12040	EMB37040	5/8	5/8	1-1/4	3-1/2
EMB12048	EMB37048	3/4	3/4	1-1/2	4
EMB12064	EMB37064	1	1	1-1/2	4

刃部公差 Mill Dia. Tolerance(mm)	柄部公差 Shank Dia. Tolerance
0~- .0012	h6

◎ : 优(Excellent) ○ : 良(Good)

碳钢 Carbon Steels	合金钢 Alloy Steels	预硬钢 Prehardened Steels	硬化钢 Hardened Steels		高硬钢 High Hardened Steels	铜 Copper	石墨 Graphite	铸铁 Cast Iron	铝 Aluminum	不锈钢 Stainless Steels	钛 Titanium	镍铁合金 Inconel
~HB225	HB225~325	HRc30~40	HRc40~45	HRc45~55	HRc55~70							
◎	○	○								◎	◎	○

硬质合金, 4刃 普通刃 圆鼻铣刀
CARBIDE, 4 FLUTE REGULAR LENGTH CORNER RADIUS

- ▶ 特殊的沟槽几何形状可以消除振动
- ▶ 设计用于加工低碳钢, 不锈钢, 铸铁, 工具钢, 钛合金, 预硬钢和硬度在H Rc 40以下的低硬化钢
- ▶ 卓越的工件的表面粗糙度
- ▶ 高速度, 较深切削和材料切除率

- ▶ Special flute geometry eliminates vibrations.
- ▶ Designed to mild steels, stainless steels, cast iron, tool steels, titanium alloys, prehardened steels and low hardness materials under HRc 40
- ▶ Excellent work piece finishes
- ▶ Higher speeds, deeper cuts and metal removal rates



P.724

型号		圆弧半径 Corner Radius	刃部直径 Mill Diameter	柄部直径 Shank Diameter	刃长 Length of Cut	单位(Unit) : inch	
EDP No.						R	全长 Overall Length
PLAIN	FLAT			h6			
EMB13008	-	R.010~R.015	1/8	1/8	3/8	1-1/2	
EMB13012	-	R.010~R.015	3/16	3/16	7/16	2	
EMB13016	-	R.015~R.020	1/4	1/4	1/2	2-1/2	
EMB13020	-	R.015~R.020	5/16	5/16	13/16	2-1/2	
EMB13024	EMB38024	R.015~R.020	3/8	3/8	7/8	2-1/2	
EMB13028	EMB38028	R.015~R.020	7/16	7/16	1	2-3/4	
EMB13032	EMB38032	R.025~R.030	1/2	1/2	1	3	
EMB13036	EMB38036	R.025~R.030	9/16	9/16	1-1/8	3-1/2	
EMB13040	EMB38040	R.035~R.040	5/8	5/8	1-1/4	3-1/2	
EMB13048	EMB38048	R.035~R.040	3/4	3/4	1-1/2	4	
EMB13064	EMB38064	R.035~R.040	1	1	1-1/2	4	

刃部公差 Mill Dia. Tolerance(mm)	柄部公差 Shank Dia. Tolerance
0~-.0012	h6

碳钢	合金钢	预硬钢	硬化钢		高硬钢	铜	石墨	铸铁	铝	不锈钢	钛	镍铁合金
Carbon Steels	Alloy Steels	Prehardened Steels	Hardened Steels		High Hardened Steels	Copper	Graphite	Cast Iron	Aluminum	Stainless Steels	Titanium	Inconel
~HB225	HB225~325	HRc30~40	HRc40~45	HRc45~55	HRc55~70							
◎	○	○								◎	◎	○

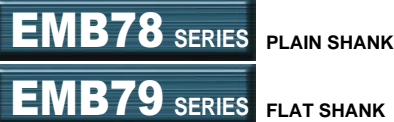

硬质合金, 4刃 普通刃 球头
CARBIDE, 4 FLUTE REGULAR LENGTH BALL NOSE

- ▶ 特殊的沟槽几何形状可以消除振动
- ▶ 设计用于加工低碳钢, 不锈钢, 铸铁, 工具钢, 钛合金, 预硬钢和硬度在HRc40以下的低硬化钢
- ▶ 卓越的工件的表面粗糙度
- ▶ 高速度, 较深切削和材料切除率
- ▶ Special flute geometry eliminates vibrations.
- ▶ Designed to mild steels, stainless steels, cast iron, tool steels, titanium alloys, prehardened steels and low hardness materials under HRc 40
- ▶ Excellent work piece finishes
- ▶ Higher speeds, deeper cuts and metal removal rates



单位(Unit) : inch

型号 EDP No.		球头半径 Radius of Ball Nose	刃部直径 Mill Diameter	柄部直径 Shank Diameter	刃长 Length of Cut	全长 Overall Length
PLAIN	FLAT	R (±.0004)		h6		
EMB78008	-	R1/16	1/8	1/8	3/8	1-1/2
EMB78010	-	R5/64	5/32	3/16	7/16	2
EMB78012	-	R3/32	3/16	3/16	7/16	2
EMB78016	-	R1/8	1/4	1/4	1/2	2-1/2
EMB78020	-	R5/32	5/16	5/16	13/16	2-1/2
EMB78024	EMB79024	R3/16	3/8	3/8	7/8	2-1/2
EMB78032	EMB79032	R1/4	1/2	1/2	1	3
EMB78040	EMB79040	R5/16	5/8	5/8	1-1/4	3-1/2
EMB78048	EMB79048	R3/8	3/4	3/4	1-1/2	4
EMB78064	EMB79064	R1/2	1	1	1-1/2	4

刃部公差 Mill Dia. Tolerance(mm)	柄部公差 Shank Dia. Tolerance
0~-.0012	h6

◎ : 优(Excellent) ○ : 良(Good)

碳钢 Carbon Steels	合金钢 Alloy Steels	预硬钢 Prehardened Steels	硬化钢 Hardened Steels		高硬钢 High Hardened Steels	铜 Copper	石墨 Graphite	铸铁 Cast Iron	铝 Aluminum	不锈钢 Stainless Steels	钛 Titanium	镍钴铁合金 Inconel
~HB225	HB225~325	HRc30~40	HRc40~45	HRc45~55	HRc55~70							
◎	○	○								◎	◎	○

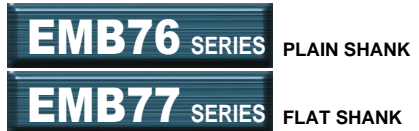

硬质合金, 5刃 普通刃
CARBIDE, 5 FLUTE REGULAR LENGTH

- ▶ 特殊的沟槽几何形状可以消除振动
- ▶ 设计用于加工低碳钢, 不锈钢, 铸铁, 工具钢, 钛合金, 预硬钢和硬度在H Rc 40以下的低硬化钢
- ▶ 卓越的工件的表面粗糙度
- ▶ 高速度, 较深切削和材料切除率

- ▶ Special flute geometry eliminates vibrations.
- ▶ Designed to mild steels, stainless steels, cast iron, tool steels, titanium alloys, prehardened steels and low hardness materials under HRc 40
- ▶ Excellent work piece finishes
- ▶ Higher speeds, deeper cuts and metal removal rates



型号		刃部直径 Mill Diameter	柄部直径 Shank Diameter h6	刃长 Length of Cut	单位(Unit) : inch	
EDP No.					全长 Overall Length	
PLAIN	FLAT					
EMB76016	-	1/4	1/4	1/2	2-1/2	
EMB76020	-	5/16	5/16	13/16	2-1/2	
EMB76024	EMB77024	3/8	3/8	7/8	2-1/2	
EMB76032	EMB77032	1/2	1/2	1	3	
EMB76036	EMB77036	9/16	9/16	1-1/8	3-1/2	
EMB76040	EMB77040	5/8	5/8	1-1/4	3-1/2	
EMB76048	EMB77048	3/4	3/4	1-1/2	4	
EMB76064	EMB77064	1	1	1-1/2	4	

刃部公差 Mill Dia. Tolerance(mm)	柄部公差 Shank Dia. Tolerance
0~- .0012	h6

◎ : 优(Excellent) ○ : 良(Good)

碳钢	合金钢	预硬钢	硬化钢		高硬钢	铜	石墨	铸铁	铝	不锈钢	钛	镍铁合金
Carbon Steels	Alloy Steels	Prehardened Steels	Hardened Steels		High Hardened Steels	Copper	Graphite	Cast Iron	Aluminum	Stainless Steels	Titanium	Inconel
~HB225	HB225~325	HRc30~40	HRc40~45	HRc45~55	HRc55~70							
◎	○	○								◎	◎	○

HSS

CBN
END MILLS

i-Xmill
END MILLS

X5070
END MILLS

X-POWER
END MILLS

JET-POWER
END MILLS

V7 Mill INOX
END MILLS

V7 Mill STEEL
END MILLS

ALU-POWER
END MILLS

CRX S

D-POWER
END MILLS

K-2 CARBIDE
END MILLS

GENERAL
CARBIDE
END MILLS

TANK-POWER
END MILLS

GENERAL
HSS
END MILLS

MILLING
CUTTERS

TECHNICAL
DATA



推荐的切削条件
RECOMMENDED CUTTING CONDITIONS

硬质合金, 4刃
CARBIDE, 4 FLUTE

EMB41, EMB42, EMB43, EMB44, EMB14, EMB39, EMB15, EMB40, EMB12, EMB37, EMB13, EMB38 SERIES

材质	合金钢, 铸铁		不锈钢, 300SERIES		不锈钢, 400SERIES		钛		铬镍铁合金	
MATERIAL	ALLOY STEELS CAST IRON		STAINLESS STEELS 300SERIES		STAINLESS STEELS 400SERIES		TITANIUM		INCONEL	
HARDNESS	~HB 230									
STRENGTH	~1000N/mm ²									
DIAMETER	RPM	FEED	RPM	FEED	RPM	FEED	RPM	FEED	RPM	FEED
3.0	13475	275	10185	195	14260	205	10185	205	2715	55
4.0	10105	330	7600	250	14260	255	7600	255	2005	55
5.0	8085	370	6110	310	8655	310	6110	310	1630	80
6.0	6735	435	5095	360	7130	360	5095	360	1355	95
8.0	5050	555	3820	435	5345	465	3280	465	1015	125
10.0	4455	690	3055	590	4275	585	3055	585	815	155
12.0	3710	695	2545	565	3565	565	2545	565	675	150
14.0	3180	620	2180	520	3055	520	2180	520	580	140
16.0	2785	590	1910	480	2670	480	1910	480	505	130
18.0	2475	585	1695	475	2375	475	1695	475	450	125
20.0	2225	580	1525	470	2140	470	1525	470	405	125
25.0	1780	450	1215	380	1710	380	1215	380	320	110

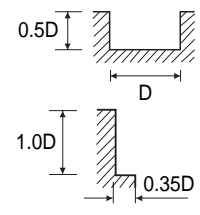
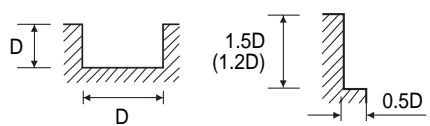

1.2D 轴向切削深度应该使用在刃径超过8mm的短刃系列
1.2 x D Axial cutting depth should be applied for Short length series DIA over 8mm

RPM = rev./min. (转速/分钟)
FEED = mm/min. (进给量)

CBN
END MILLS

i-Xmill
END MILLS

X5070
END MILLS

X-POWER
END MILLS

JET-POWER
END MILLS

V7 Mill INOX
END MILLS

V7 Mill STEEL
END MILLS

ALU-POWER
END MILLS

CRX S

D-POWER
END MILLS

K-2 CARBIDE
END MILLS

GENERAL
CARBIDE
END MILLS

TANK-POWER
END MILLS

GENERAL
HSS
END MILLS

MILLING
CUTTERS

TECHNICAL
DATA

**硬质合金, 4刃 球头
CARBIDE, 4 FLUTE BALL NOSE**
CBN
END MILLSi-Xmill
END MILLSX5070
END MILLSX-POWER
END MILLSJET-POWER
END MILLSV7 Mill INOX
END MILLSV7 Mill STEEL
END MILLSALU-POWER
END MILLS

CRX S

D-POWER
END MILLSK-2 CARBIDE
END MILLSGENERAL
CARBIDE
END MILLSTANK-POWER
END MILLSGENERAL
HSS
END MILLSMILLING
CUTTERSTECHNICAL
DATA
EMB74, EMB75, EMB78, EMB79 SERIES

材质	合金钢, 铸铁		不锈钢, 300SERIES		不锈钢, 400SERIES		钛		铬镍铁合金		
MATERIAL	ALLOY STEELS CAST IRON		STAINLESS STEELS 300SERIES		STAINLESS STEELS 400SERIES		TITANIUM		INCONEL		
HARDNESS	~HB 230										
STRENGTH	~1000N/mm ²										
DIAMETER	RPM	FEED	RPM	FEED	RPM	FEED	RPM	FEED	RPM	FEED	
R1.5 × 3.0	14324	1430	8220	650	7420	440	5830	280	3180	140	
R2.0 × 4.0	10740	1070	6160	490	5570	330	4370	210	2380	100	
R2.5 × 5.0	8590	1030	4930	490	4450	440	3500	210	1910	80	
R3.0 × 6.0	7460	1140	4110	670	3710	440	2910	230	1590	100	
R4.0 × 8.0	5370	1280	3080	550	2780	440	2180	260	1190	120	
R5.0 × 10.0	4290	1030	2460	490	2220	400	1750	210	950	100	
R6.0 × 12.0	3580	1000	2050	450	1850	370	1450	230	790	120	
R8.0 × 16.0	2680	800	1540	370	1390	300	1090	190	590	110	
R9.0 × 18.0	2380	760	1370	350	1230	290	970	190	530	110	
R10.0 × 20.0	2140	770	1230	320	1110	260	870	210	470	100	
R12.5 × 25.0	1710	680	980	270	890	210	700	190	380	80	

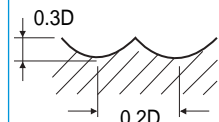
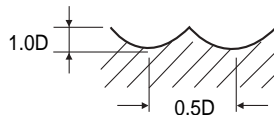
 RPM = rev./min. (转速/分钟)
 FEED = mm/min. (进给量)

**硬质合金, 5刃
CARBIDE, 5 FLUTE**
EMB72, EMB73, EMB76, EMB77 SERIES

材质	合金钢, 铸铁		不锈钢, 300SERIES		不锈钢, 400SERIES		钛		铬镍铁合金		
MATERIAL	ALLOY STEELS CAST IRON		STAINLESS STEELS 300SERIES		STAINLESS STEELS 400SERIES		TITANIUM		INCONEL		
HARDNESS	~HB 230										
STRENGTH	~1000N/mm ²										
DIAMETER	RPM	FEED	RPM	FEED	RPM	FEED	RPM	FEED	RPM	FEED	
6.0	7270	1240	6060	920	5660	860	4440	670	1450	120	
8.0	5450	1040	4540	720	4240	670	3330	520	1090	110	
10.0	4360	1100	3630	690	3390	640	2660	500	870	110	
12.0	3630	1150	3030	960	3830	820	2220	560	720	130	
14.0	3110	1080	2600	850	2420	770	1900	540	620	140	
16.0	2720	1040	2270	780	2120	720	1660	520	540	130	
18.0	2420	1000	2020	710	1880	670	1480	510	480	130	
20.0	2180	970	1810	690	1690	640	1330	500	430	130	
25.0	1740	880	1450	640	1350	600	1060	470	340	130	

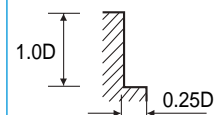
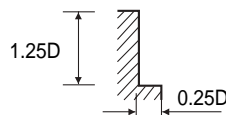
 RPM = rev./min. (转速/分钟)
 FEED = mm/min. (进给量)

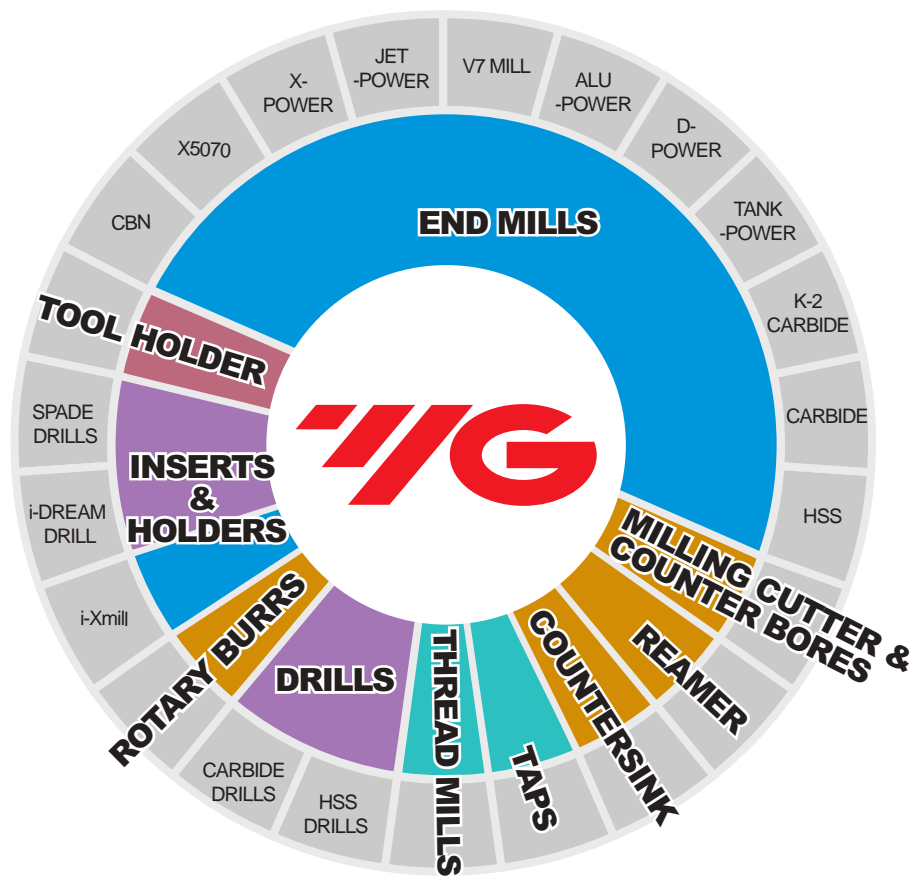

Challenge toward a Global Leader-

YG-1 Leads the World Market.